

◀◀ Inductive Sensor

Metal Barrel-M18



Description:

Brass nickel-plated, threaded barrel, DC 2-wire output, IP67 protection class, LED indicator.

Technical Data:

Type	Rated Operating Distance S_n	Mounting	Output	Voltage Range U_B	Rated Current	Switching Frequency	Ambient Temperature	Connection	Fig
Fi5-M18-OD6L	5mm	Flush	DC NO	10...30VDC	≤100mA	800Hz	-25...70°C	2m cable	Fig.1
Fi5-M18-CD6L	5mm	Flush	DC NC	10...30VDC	≤100mA	800Hz	-25...70°C	2m cable	Fig.1
Ni8-M18-OD6L	8mm	Non-flush	DC NO	10...30VDC	≤100mA	500Hz	-25...70°C	2m cable	Fig.2
Ni8-M18-CD6L	8mm	Non-flush	DC NC	10...30VDC	≤100mA	500Hz	-25...70°C	2m cable	Fig.2
Fi5-M18-OD6L-Q12	5mm	Flush	DC NO	10...30VDC	≤100mA	800Hz	-25...70°C	M12 Connector	Fig.3
Fi5-M18-CD6L-Q12	5mm	Flush	DC NC	10...30VDC	≤100mA	800Hz	-25...70°C	M12 Connector	Fig.3
Ni8-M18-OD6L-Q12	8mm	Non-flush	DC NO	10...30VDC	≤100mA	500Hz	-25...70°C	M12 Connector	Fig.4
Ni8-M18-CD6L-Q12	8mm	Non-flush	DC NC	10...30VDC	≤100mA	500Hz	-25...70°C	M12 Connector	Fig.4

Dimensions:

Fig.1

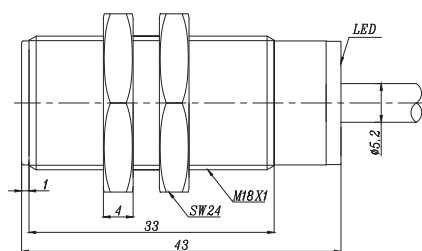

Fig.2

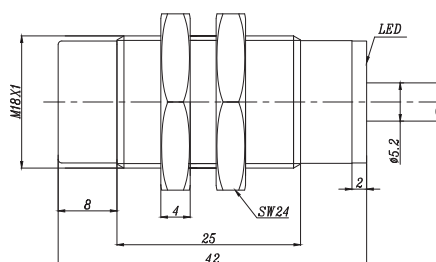

Fig.3

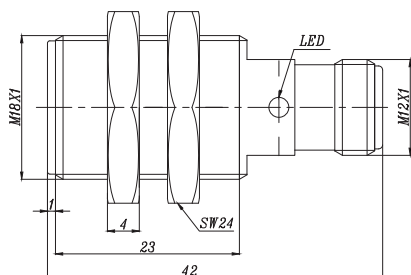
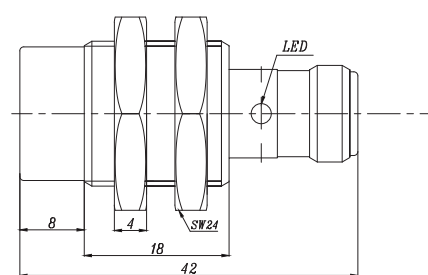

Fig.4



Metal Barrel-M18



Description:

Brass nickel-plated, threaded barrel, DC 3-wire output, IP67 protection class, LED indicator.

Inductive Sensors

Technical Data:

Type	Rated Operating Distance S_n	Mounting	Output	Voltage Range U_B	Rated Current	Switching Frequency	Ambient Temperature	Connection	Fig
Fi5-M18-OP6L	5mm	Flush	PNP NO	10...30VDC	≤200mA	800Hz	-25...70°C	2m cable	Fig.1
Fi5-M18-ON6L	5mm	Flush	NPN NO	10...30VDC	≤200mA	800Hz	-25...70°C	2m cable	Fig.1
Fi5-M18-CP6L	5mm	Flush	PNP NC	10...30VDC	≤200mA	800Hz	-25...70°C	2m cable	Fig.1
Fi5-M18-CN6L	5mm	Flush	NPN NC	10...30VDC	≤200mA	800Hz	-25...70°C	2m cable	Fig.1
Ni8-M18-OP6L	8mm	Non-flush	PNP NO	10...30VDC	≤200mA	500Hz	-25...70°C	2m cable	Fig.2
Ni8-M18-ON6L	8mm	Non-flush	NPN NO	10...30VDC	≤200mA	500Hz	-25...70°C	2m cable	Fig.2
Ni8-M18-CP6L	8mm	Non-flush	PNP NC	10...30VDC	≤200mA	500Hz	-25...70°C	2m cable	Fig.2
Ni8-M18-CN6L	8mm	Non-flush	NPN NC	10...30VDC	≤200mA	500Hz	-25...70°C	2m cable	Fig.2
Fi5-M18-OP6L-Q12	5mm	Flush	PNP NO	10...30VDC	≤200mA	800Hz	-25...70°C	M12 Connector	Fig.3
Fi5-M18-ON6L-Q12	5mm	Flush	NPN NO	10...30VDC	≤200mA	800Hz	-25...70°C	M12 Connector	Fig.3
Fi5-M18-CP6L-Q12	5mm	Flush	PNP NC	10...30VDC	≤200mA	800Hz	-25...70°C	M12 Connector	Fig.3
Fi5-M18-CN6L-Q12	5mm	Flush	NPN NC	10...30VDC	≤200mA	800Hz	-25...70°C	M12 Connector	Fig.3
Ni8-M18-OP6L-Q12	8mm	Non-flush	PNP NO	10...30VDC	≤200mA	500Hz	-25...70°C	M12 Connector	Fig.4
Ni8-M18-ON6L-Q12	8mm	Non-flush	NPN NO	10...30VDC	≤200mA	500Hz	-25...70°C	M12 Connector	Fig.4
Ni8-M18-CP6L-Q12	8mm	Non-flush	PNP NC	10...30VDC	≤200mA	500Hz	-25...70°C	M12 Connector	Fig.4
Ni8-M18-CN6L-Q12	8mm	Non-flush	NPN NC	10...30VDC	≤200mA	500Hz	-25...70°C	M12 Connector	Fig.4

Dimensions:

Fig.1

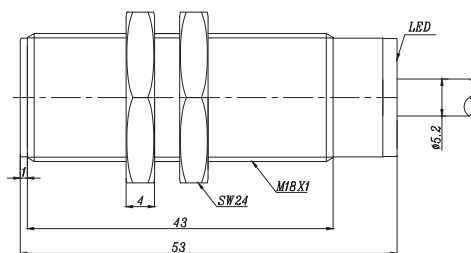

Fig.2

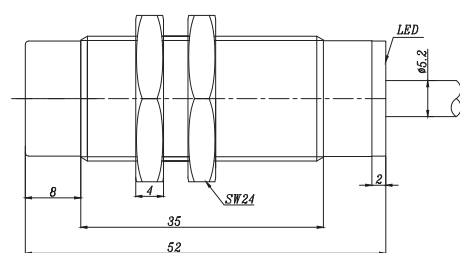

Fig.3

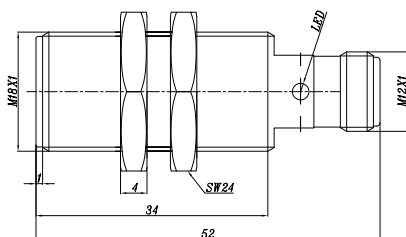
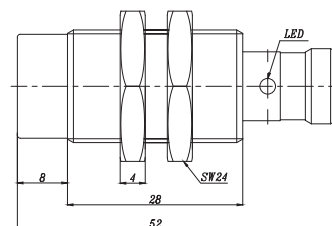

Fig.4



<< Inductive Sensor

Metal Barrel-M18



Description:

Brass nickel-plated, threaded barrel, DC 4-wire output, IP67 protection class, LED indicator.

Technical Data:

Type	Rated Operating Distance S_n	Mounting	Output	Voltage Range U_n	Rated Current	Switching Frequency	Ambient Temperature	Connection	Fig
Fi5-M18-BP6L	5mm	Flush	PNP NO+NC	10...30VDC	≤200mA	800Hz	-25...70°C	2m cable	Fig.1
Fi5-M18-BN6L	5mm	Flush	NPN NO+NC	10...30VDC	≤200mA	800Hz	-25...70°C	2m cable	Fig.1
Ni8-M18-BP6L	8mm	Non-flush	PNP NO+NC	10...30VDC	≤200mA	500Hz	-25...70°C	2m cable	Fig.2
Ni8-M18-BN6L	8mm	Non-flush	NPN NO+NC	10...30VDC	≤200mA	500Hz	-25...70°C	2m cable	Fig.2
Fi5-M18-BP6L-Q12	5mm	Flush	PNP NO+NC	10...30VDC	≤200mA	800Hz	-25...70°C	M12 Connector	Fig.3
Fi5-M18-BN6L-Q12	5mm	Flush	NPN NO+NC	10...30VDC	≤200mA	800Hz	-25...70°C	M12 Connector	Fig.3
Ni8-M18-BP6L-Q12	8mm	Non-flush	PNP NO+NC	10...30VDC	≤200mA	500Hz	-25...70°C	M12 Connector	Fig.4
Ni8-M18-BN6L-Q12	8mm	Non-flush	NPN NO+NC	10...30VDC	≤200mA	500Hz	-25...70°C	M12 Connector	Fig.4

Dimensions:

Fig.1

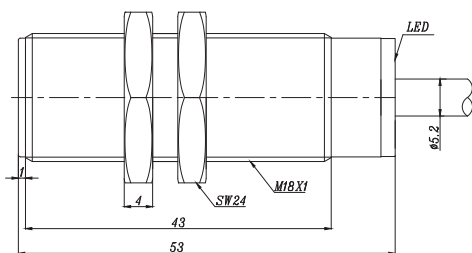

Fig.2

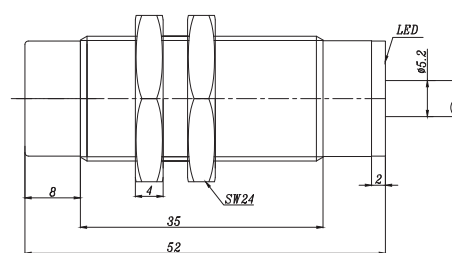

Fig.3

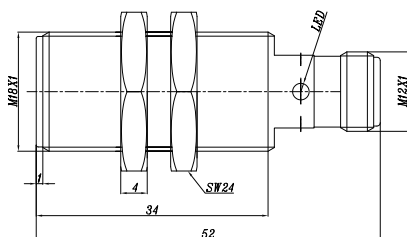
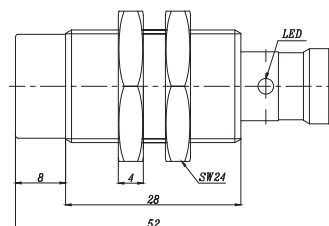

Fig.4



Metal Barrel-M18



Description:

Brass nickel-plated, threaded barrel, AC 2-wire output, IP67 protection class, LED indicator.

Inductive Sensors

Technical Data:

Type	Rated Operating Distance S _n	Mounting	Output	Voltage Range U _s	Rated Current	Switching Frequency	Ambient Temperature	Connection	Fig
Fi5-M18-OSA3L	5mm	Flush	AC NO	20...250VAC	≤200mA	40Hz	-25...70°C	2m cable	Fig.1
Fi5-M18-CSA3L	5mm	Flush	AC NC	20...250VAC	≤200mA	40Hz	-25...70°C	2m cable	Fig.1
Ni8-M18-OSA3L	8mm	Non-flush	AC NO	20...250VAC	≤200mA	40Hz	-25...70°C	2m cable	Fig.2
Ni8-M18-CSA3L	8mm	Non-flush	AC NC	20...250VAC	≤200mA	40Hz	-25...70°C	2m cable	Fig.2
Fi5-M18-OSA3L-Q12	5mm	Flush	AC NO	20...250VAC	≤200mA	40Hz	-25...70°C	M12 Connector	Fig.3
Fi5-M18-CSA3L-Q12	5mm	Flush	AC NC	20...250VAC	≤200mA	40Hz	-25...70°C	M12 Connector	Fig.3
Ni8-M18-OSA3L-Q12	8mm	Non-flush	AC NO	20...250VAC	≤200mA	40Hz	-25...70°C	M12 Connector	Fig.4
Ni8-M18-CSA3L-Q12	8mm	Non-flush	AC NC	20...250VAC	≤200mA	40Hz	-25...70°C	M12 Connector	Fig.4

Fig.1

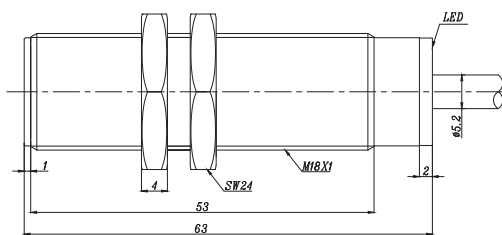

Fig.2

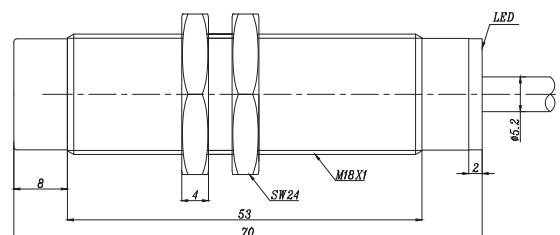

Fig.3

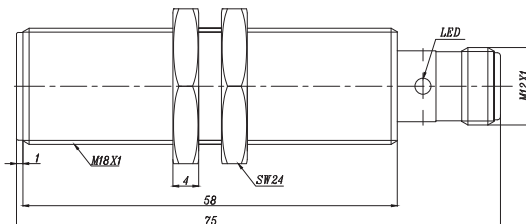
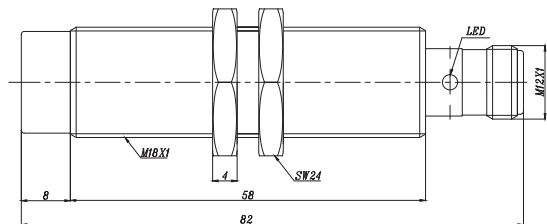

Fig.4



Inductive Sensor

Metal Barrel-M18



Description:

Brass nickel-plated, threaded barrel, AC/DC 2-wire output, IP67 protection class, LED indicator.

Technical Data:

Type	Rated Operating Distance Sn	Mounting	Output	Voltage Range U ₃	Rated Current	Switching Frequency	Ambient Temperature	Connection	Fig
F5-M18-OA41L	5mm	Flush	DC/AC NO	20...250VAC/DC	DC≤100mA/AC≤200mA	40Hz	-25...70°C	2m cable	Fig.1
F5-M18-CA41L	5mm	Flush	DC/AC NC	20...250VAC/DC	DC≤100mA/AC≤200mA	40Hz	-25...70°C	2m cable	Fig.1
N8-M18-OA41L	8mm	Non-flush	DC/AC NO	20...250VAC/DC	DC≤100mA/AC≤200mA	40Hz	-25...70°C	2m cable	Fig.2
N8-M18-CA41L	8mm	Non-flush	DC/AC NC	20...250VAC/DC	DC≤100mA/AC≤200mA	40Hz	-25...70°C	2m cable	Fig.2
F5-M18-OA41L-Q12	5mm	Flush	DC/AC NO	20...250VAC/DC	DC≤100mA/AC≤200mA	40Hz	-25...70°C	M12 Connector	Fig.3
F5-M18-CA41L-Q12	5mm	Flush	DC/AC NC	20...250VAC/DC	DC≤100mA/AC≤200mA	40Hz	-25...70°C	M12 Connector	Fig.3
N8-M18-OA41L-Q12	8mm	Non-flush	DC/AC NO	20...250VAC/DC	DC≤100mA/AC≤200mA	40Hz	-25...70°C	M12 Connector	Fig.4
N8-M18-CA41L-Q12	8mm	Non-flush	DC/AC NC	20...250VAC/DC	DC≤100mA/AC≤200mA	40Hz	-25...70°C	M12 Connector	Fig.4

Dimensions:

Fig.1

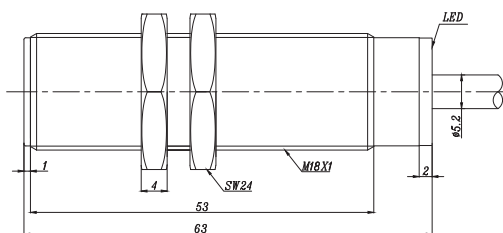

Fig.2

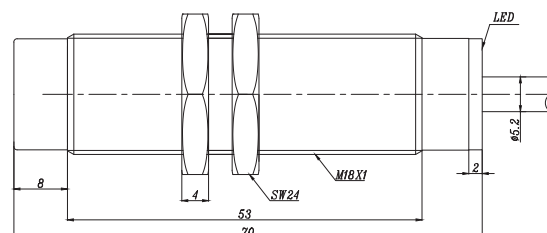

Fig.3

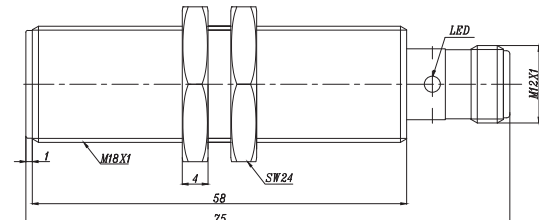
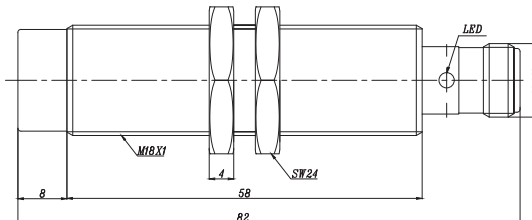

Fig.4



Long-Sensing Metal Barrel-M18



Description:

Brass nickel-plated, threaded barrel, extended operating distance, DC 2-wire output, IP67 protection class, LED indicator.

Inductive Sensors

Technical Data:

Type	Rated Operating Distance Sn	Mounting	Output	Voltage Range U_B	Rated Current	Switching Frequency	Ambient Temperature	Connection	Fig
Fi8-M18-OD6L	8mm	Flush	NO DC	10...30VDC	≤100mA	500Hz	-25...70°C	2m cable	Fig.1
Fi8-M18-CD6L	8mm	Flush	NC DC	10...30VDC	≤100mA	500Hz	-25...70°C	2m cable	Fig.1
Ni12-M18-OD6L	12mm	Non-flush	NO DC	10...30VDC	≤100mA	350Hz	-25...70°C	2m cable	Fig.2
Ni12-M18-CD6L	12mm	Non-flush	NC DC	10...30VDC	≤100mA	350Hz	-25...70°C	2m cable	Fig.2
Fi8-M18-OD6L-Q12	8mm	Flush	NO DC	10...30VDC	≤100mA	500Hz	-25...70°C	M12 Connector	Fig.3
Fi8-M18-CD6L-Q12	8mm	Flush	NC DC	10...30VDC	≤100mA	500Hz	-25...70°C	M12 Connector	Fig.3
Ni12-M18-OD6L-Q12	12mm	Non-flush	NO DC	10...30VDC	≤100mA	350Hz	-25...70°C	M12 Connector	Fig.4
Ni12-M18-CD6L-Q12	12mm	Non-flush	NC DC	10...30VDC	≤100mA	350Hz	-25...70°C	M12 Connector	Fig.4

Dimensions:

Fig.1

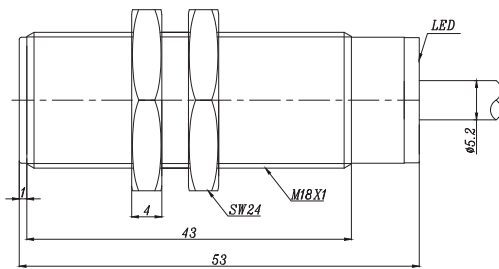

Fig.2

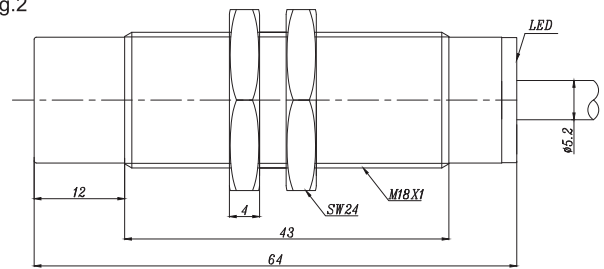

Fig.3

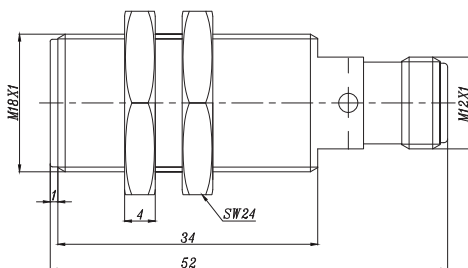
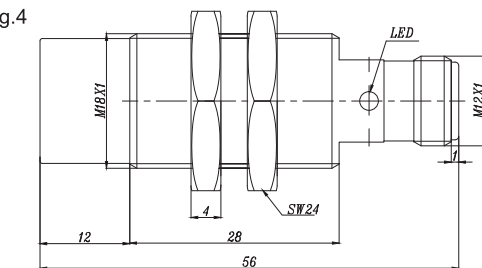

Fig.4



◀◀ Inductive Sensor

Long-Sensing Metal Barrel-M18



Description:

Brass nickel-plated, threaded barrel, extended operating distance, DC 3-wire output, IP67 protection class, LED indicator.

Technical Data:

Type	Rated Operating Distance S_n	Mounting	Output	Voltage Range U_n	Rated Current	Switching Frequency	Ambient Temperature	Connection	Fig
Fi8-M18-OP6L	8mm	Flush	NO PNP	10...30VDC	≤200mA	500Hz	-25...70°C	2m cable	Fig.1
Fi8-M18-ON6L	8mm	Flush	NO NPN	10...30VDC	≤200mA	500Hz	-25...70°C	2m cable	Fig.1
Fi8-M18-CP6L	8mm	Flush	NC PNP	10...30VDC	≤200mA	500Hz	-25...70°C	2m cable	Fig.1
Fi8-M18-CN6L	8mm	Flush	NC NPN	10...30VDC	≤200mA	500Hz	-25...70°C	2m cable	Fig.1
Ni12-M18-OP6L	12mm	Non-flush	NO PNP	10...30VDC	≤200mA	350Hz	-25...70°C	2m cable	Fig.2
Ni12-M18-ON6L	12mm	Non-flush	NO NPN	10...30VDC	≤200mA	350Hz	-25...70°C	2m cable	Fig.2
Ni12-M18-CP6L	12mm	Non-flush	NC PNP	10...30VDC	≤200mA	350Hz	-25...70°C	2m cable	Fig.2
Ni12-M18-CN6L	12mm	Non-flush	NC NPN	10...30VDC	≤200mA	350Hz	-25...70°C	2m cable	Fig.2
Fi8-M18-OP6L-Q12	8mm	Flush	NO PNP	10...30VDC	≤200mA	500Hz	-25...70°C	M12 Connector	Fig.3
Fi8-M18-ON6L-Q12	8mm	Flush	NO NPN	10...30VDC	≤200mA	500Hz	-25...70°C	M12 Connector	Fig.3
Fi8-M18-CP6L-Q12	8mm	Flush	NC PNP	10...30VDC	≤200mA	500Hz	-25...70°C	M12 Connector	Fig.3
Fi8-M18-CN6L-Q12	8mm	Flush	NC NPN	10...30VDC	≤200mA	500Hz	-25...70°C	M12 Connector	Fig.3
Ni12-M18-OP6L-Q12	12mm	Non-flush	NO PNP	10...30VDC	≤200mA	350Hz	-25...70°C	M12 Connector	Fig.4
Ni12-M18-ON6L-Q12	12mm	Non-flush	NO NPN	10...30VDC	≤200mA	350Hz	-25...70°C	M12 Connector	Fig.4
Ni12-M18-CP6L-Q12	12mm	Non-flush	NC PNP	10...30VDC	≤200mA	350Hz	-25...70°C	M12 Connector	Fig.4
Ni12-M18-CN6L-Q12	12mm	Non-flush	NC NPN	10...30VDC	≤200mA	350Hz	-25...70°C	M12 Connector	Fig.4

Dimensions:

Fig.1

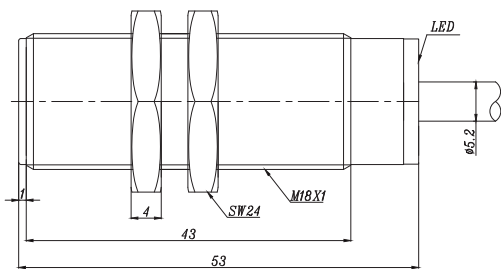

Fig.2

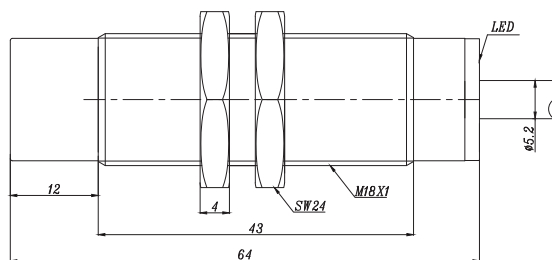

Fig.3

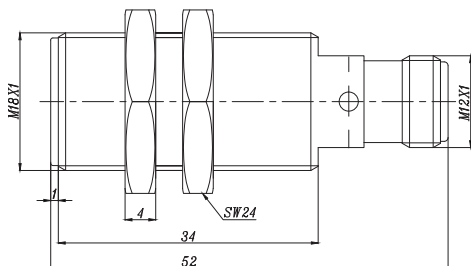
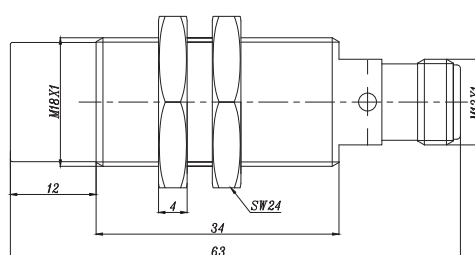

Fig.4



Long-Sensing Metal Barrel-M18



Description:

Brass nickel-plated, threaded barrel, extended operating distance, DC 3-wire output, IP67 protection class, LED indicator.

Inductive Sensors

Technical Data:

Type	Rated Operating Distance S_n	Mounting	Output	Voltage Range U_a	Rated Current	Switching Frequency	Ambient Temperature	Connection	Fig
Fi8-M18-BP6L	8mm	Flush	NO+NC PNP	10...30VDC	$\leq 200\text{mA}$	500Hz	-25...70°C	2m cable	Fig.1
Fi8-M18-BN6L	8mm	Flush	NO+NC NPN	10...30VDC	$\leq 200\text{mA}$	500Hz	-25...70°C	2m cable	Fig.1
Ni12-M18-BP6L	12mm	Non-flush	NO+NC PNP	10...30VDC	$\leq 200\text{mA}$	350Hz	-25...70°C	2m cable	Fig.2
Ni12-M18-BN6L	12mm	Non-flush	NO+NC NPN	10...30VDC	$\leq 200\text{mA}$	350Hz	-25...70°C	2m cable	Fig.2
Fi8-M18-BP6L-Q12	8mm	Flush	NO+NC PNP	10...30VDC	$\leq 200\text{mA}$	500Hz	-25...70°C	M12 Connector	Fig.3
Fi8-M18-BN6L-Q12	8mm	Flush	NO+NC NPN	10...30VDC	$\leq 200\text{mA}$	500Hz	-25...70°C	M12 Connector	Fig.3
Ni12-M18-BP6L-Q12	12mm	Non-flush	NO+NC PNP	10...30VDC	$\leq 200\text{mA}$	350Hz	-25...70°C	M12 Connector	Fig.4
Ni12-M18-BN6L-Q12	12mm	Non-flush	NO+NC NPN	10...30VDC	$\leq 200\text{mA}$	350Hz	-25...70°C	M12 Connector	Fig.4

Dimensions:

Fig.1

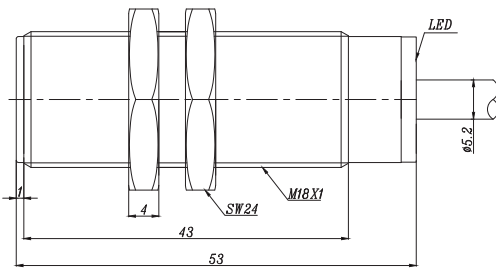

Fig.2

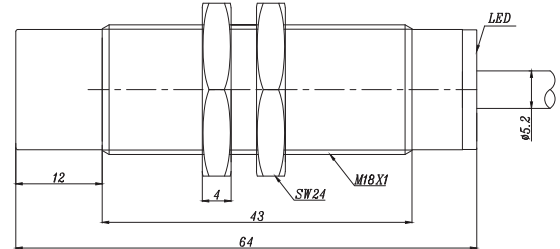

Fig.3

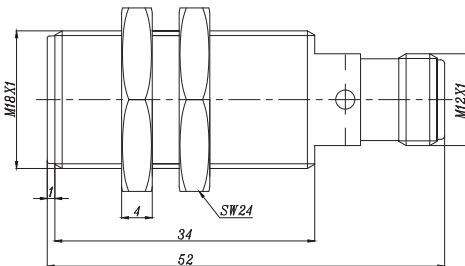
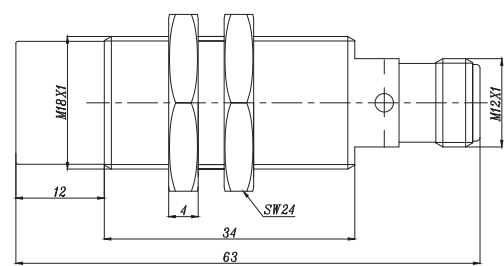

Fig.4



◀◀ Inductive Sensor

Long-Sensing Metal Barrel-M18



Description:

Brass nickel-plated, threaded barrel, extended operating distance, AC 2-wire output, IP67 protection class, LED indicator.

Technical Data:

Type	Rated Operating Distance Sn	Mounting	Output	Voltage Range U_B	Rated Current	Switching Frequency	Ambient Temperature	Connection	Fig
Fi8-M18-OSA3L	8mm	Flush	NO AC	20...250VAC	≤200mA	40Hz	-25...70°C	2m cable	Fig.1
Fi8-M18-CSA3L	8mm	Flush	NC AC	20...250VAC	≤200mA	40Hz	-25...70°C	2m cable	Fig.1
Ni12-M18-OSA3L	12mm	Non-flush	NO AC	20...250VAC	≤200mA	40Hz	-25...70°C	2m cable	Fig.2
Ni12-M18-CSA3L	12mm	Non-flush	NC AC	20...250VAC	≤200mA	40Hz	-25...70°C	2m cable	Fig.2
Fi8-M18-OSA3L-Q12	8mm	Flush	NO AC	20...250VAC	≤200mA	40Hz	-25...70°C	M12 Connector	Fig.3
Fi8-M18-CSA3L-Q12	8mm	Flush	NC AC	20...250VAC	≤200mA	40Hz	-25...70°C	M12 Connector	Fig.3
Ni12-M18-OSA3L-Q12	12mm	Non-flush	NO AC	20...250VAC	≤200mA	40Hz	-25...70°C	M12 Connector	Fig.4
Ni12-M18-CSA3L-Q12	12mm	Non-flush	NC AC	20...250VAC	≤200mA	40Hz	-25...70°C	M12 Connector	Fig.4

Dimensions:

Fig.1

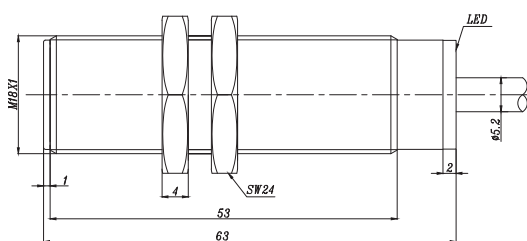

Fig.2

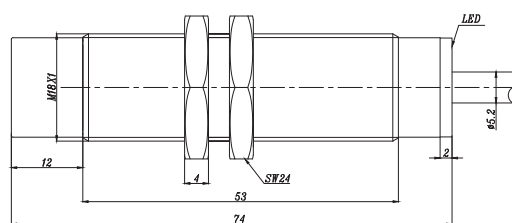

Fig.3

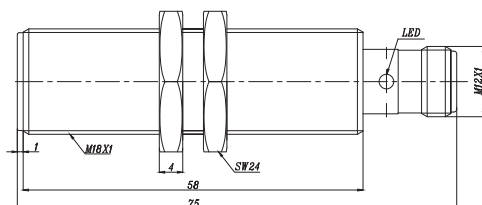
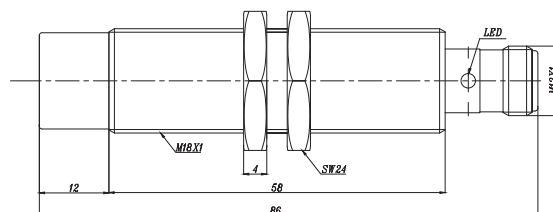

Fig.4



Long-Sensing Metal Barrel-M18



Description:

Brass nickel-plated, threaded barrel, extended operating distance, AC 2-wire output, IP67 protection class, LED indicator.

Inductive Sensors

Technical Data:

Type	Rated Operating Distance Sn	Mounting	Output	Voltage Range U _B	Rated Current	Switching Frequency	Ambient Temperature	Connection	Fig
Fi8-M18-OA41L	8mm	Flush	NO DC/AC	20...250VAC/DC	DC≤100mA/AC≤200mA	20/500Hz	-25...70°C	2m cable	Fig.1
Fi8-M18-CA41L	8mm	Flush	NC DC/AC	20...250VAC/DC	DC≤100mA/AC≤200mA	20/500Hz	-25...70°C	2m cable	Fig.1
Ni12-M18-OA41L	12mm	Non-flush	NO DC/AC	20...250VAC/DC	DC≤100mA/AC≤200mA	20/350Hz	-25...70°C	2m cable	Fig.2
Ni12-M18-CA41L	12mm	Non-flush	NC DC/AC	20...250VAC/DC	DC≤100mA/AC≤200mA	20/350Hz	-25...70°C	2m cable	Fig.2
Fi8-M18-OA41L-Q12	8mm	Flush	NO DC/AC	20...250VAC/DC	DC≤100mA/AC≤200mA	20/500Hz	-25...70°C	M12 Connector	Fig.3
Fi8-M18-CA41L-Q12	8mm	Flush	NC DC/AC	20...250VAC/DC	DC≤100mA/AC≤200mA	20/500Hz	-25...70°C	M12 Connector	Fig.3
Ni12-M18-OA41L-Q12	12mm	Non-flush	NO DC/AC	20...250VAC/DC	DC≤100mA/AC≤200mA	20/350Hz	-25...70°C	M12 Connector	Fig.4
Ni12-M18-CA41L-Q12	12mm	Non-flush	NC DC/AC	20...250VAC/DC	DC≤100mA/AC≤200mA	20/350Hz	-25...70°C	M12 Connector	Fig.4

Dimensions:

Fig.1

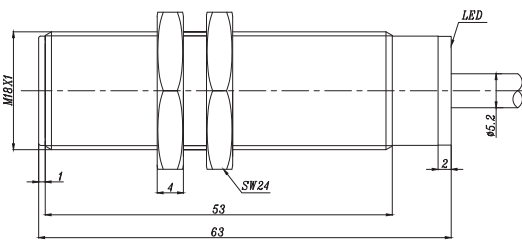

Fig.2

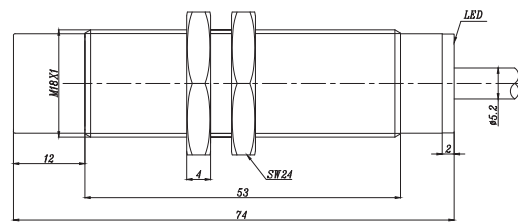

Fig.3

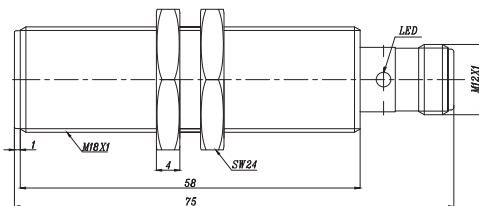

Fig.4

